

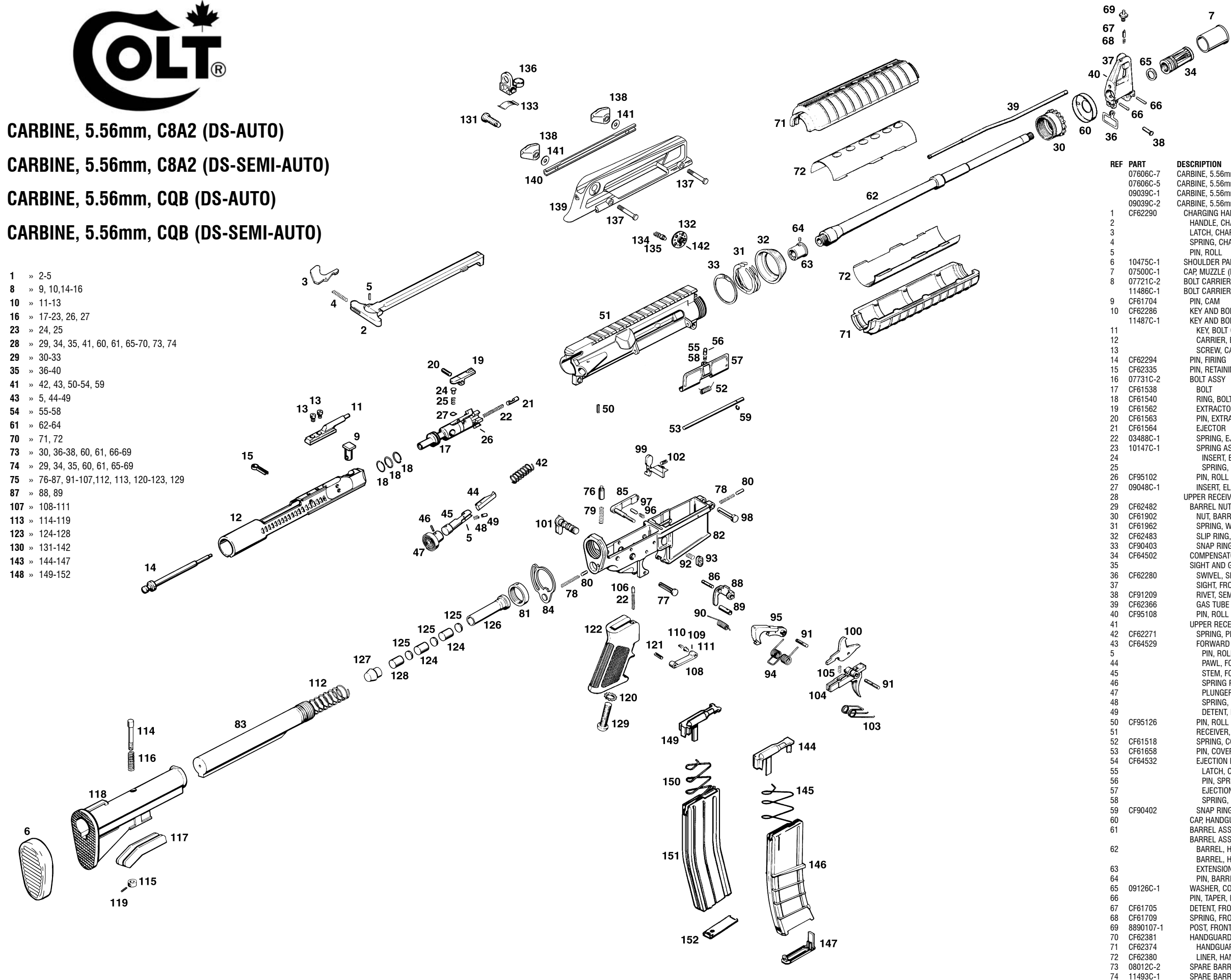

**CARBINE, 5.56mm, C8A2 (DS-AUTO)**  
**CARBINE, 5.56mm, C8A2 (DS-SEMI-AUTO)**  
**CARBINE, 5.56mm, CQB (DS-AUTO)**  
**CARBINE, 5.56mm, CQB (DS-SEMI-AUTO)**

- 1 » 2-5
- 8 » 9, 10, 14-16
- 10 » 11-13
- 16 » 17-23, 26, 27
- 23 » 24, 25
- 28 » 29, 34, 35, 41, 60, 61, 65-70, 73, 74
- 29 » 30-33
- 35 » 36-40
- 41 » 42, 43, 50-54, 59
- 43 » 5, 44-49
- 54 » 55-58
- 61 » 62-64
- 70 » 71, 72
- 73 » 30, 36-38, 60, 61, 66-69
- 74 » 29, 34, 35, 60, 61, 65-69
- 75 » 76-87, 91-107, 112, 113, 120-123, 129
- 87 » 88, 89
- 107 » 108-111
- 113 » 114-119
- 123 » 124-128
- 130 » 131-142
- 143 » 144-147
- 148 » 149-152



REF	PART	DESCRIPTION	REF	PART	DESCRIPTION (cont)
1	07606C-7	CARBINE, 5.56mm, C8A2 (DS-AUTO) A	75		LOWER RECEIVER AND BUTTSTOCK ASSY
2	07606C-5	CARBINE, 5.56mm, C8A2 (DS-SEMI-AUTO) SA	76	CF61582	RETAINER, BUFFER
3	09039C-1	CARBINE, 5.56mm, CQB (DS-AUTO) A	77	CF61655	PIN, TAKEDOWN
4	09039C-2	CARBINE, 5.56mm, CQB (DS-SEMI-AUTO) SA	78	CF61692	SPRING, DETENT, TAKEDOWN PIN
5	CF62290	CHARGING HANDLE ASSY	79	CF61694	SPRING, BUFFER RETAINER
6	10475C-1	SHOULDER PAD, BUTTSTOCK	80	CF61698	DETENT, TAKEDOWN PIN
7	07500C-1	CAP, MUZZLE (BLACK)	81	CF62357	NUT, RECEIVER EXTENSION
8	07721C-2	BOLT CARRIER ASSY (A)	82		RECEIVER, LOWER-MRKG (UNDEFINED-SALES)
9	CF61704	PIN, CAM	83	07922C-2	EXTENSION, RECEIVER, 3 POSITION
10	CF62286	KEY AND BOLT CARRIER ASSY (A)	84	10513C-1	PLATE ASSY W/SLING LOOP
11	11487C-1	KEY AND BOLT CARRIER ASSY (SA)	85	CF61604	CATCH, MAGAZINE
12		KEY, BOLT CARRIER	86	CF61615	PIN, AUTOMATIC SEAR (AUTO ONLY)
13		CARRIER, BOLT	87	CF61622	AUTOMATIC SEAR ASSY (AUTO ONLY)
14	CF62294	SCREW, CAP, HEXAGON SOCKET HEAD	88	CF61590	SEAR, AUTOMATIC (AUTO ONLY)
15	CF62335	PIN, FIRING	89	CF61609	BUSHING, AUTOMATIC SEAR (AUTO ONLY)
16	07731C-2	PIN, RETAINING, FIRING PIN	90	CF61616	SPRING, AUTOMATIC SEAR (AUTO ONLY)
17	CF61538	BOLT ASSY	91	CF61654	PIN, HAMMER & TRIGGER
18	CF61540	BOLT	92	CF61759	SPRING, MAGAZINE CATCH
19	CF61562	RING, BOLT	93	CF62032	BUTTON, MAGAZINE RELEASE
20	CF61563	EXTRACTOR	94	CF61697	SPRING, HAMMER
21	CF61564	PIN, EXTRACTOR	95	CF62317	HAMMER AND HAMMER PIN RTNR ASSY (A)
22	03488C-1	EJECTOR	96	11481C-1	HAMMER AND HAMMER PIN RTNR ASSY (SA)
23	10147C-1	SPRING, EJECTOR	97	CF62177	SPRING, BOLT CATCH
24		SPRING ASSY, EXTRACTOR	98	CF62178	PLUNGER, BOLT CATCH
25		INSERT, EXTRACTOR (BLACK)	99	CF62221	PIN, RECEIVER PIVOT
26	CF95102	SPRING, EXTRACTOR	100	CF62334	CATCH, BOLT
27	09048C-1	PIN, ROLL	101	11483C-1	DISCONNECT (AUTO)
28		INSERT, ELAST - EXTRACTOR (CQB & C8A2 A)	102	CF64564	DISCONNECT (SEMI-AUTO)
29	CF62482	UPPER RECEIVER AND BARREL ASSY	103	9283451-1	SELECTOR, FIRE CONTROL (A)
30	CF61902	BARREL NUT ASSY	104	CF61505	SELECTOR, FIRE CONTROL (SA)
31	CF61962	NUT, BARREL	105	CF95105	PIN, ROLL
32	CF62483	SPRING, WELD ASSY, HAND GUARD SLIP RING.	106	CF61657	SPRING, TRIGGER
33	CF90403	SLIP RING, HANDGUARD	107	CF61955	TRIGGER
34	CF64502	SNAP RING, HANDGUARD	108	07992C-1	SPRING, DISCONNECT (BLACK)
35		COMPENSATOR	109		SPRING, SAFETY DETENT
36	CF62280	SIGHT AND GAS TUBE ASSY (C8)	110	CF61785	DETENT, FIRE CONTROL SELECTOR
37		SWIVEL, SLING	111	CF61970	TRIGGER GUARD ASSY
38	CF91209	SIGHT, FRONT (C7)	112		GUARD, TRIGGER
39	CF62366	RIVET, SEMI-TUBULAR	113	CF64822	PLUNGER, TRIGGER GUARD
40	CF95108	GAS TUBE ASSY	114	CF62361	SPRING, TRIGGER GUARD
41		PIN, ROLL	115		PIN, ROLL
42		UPPER RECEIVER ASSY	116	CF62369	SPRING, ACTION
43	CF62271	SPRING, PLUNGER	117	CF62373	SLIDING BUTTSTOCK ASSY
44	CF64529	FORWARD ASSIST ASSY	118	CF64822	PIN, LOCK
45		PIN, ROLL	119	CF62361	NUT, LOCK PIN
46		PAWL, FORWARD ASSIST	120	CF62368	SPRING, LOCKING
47		STEM, FORWARD ASSIST	121	CF62369	LEVER, RELEASE
48		SPRING PIN, PLUNGER ASSY	122		BUTTSTOCK, SLIDING (PLASTIC)
49		PLUNGER, FORWARD ASSIST	123	CF95142	PIN, ROLL
50		SPRING, PAWL DETENT	124	CF95106	WASHER, LOCK
51	CF95126	DETENT, PAWL	125	CF64576	PIN, ROLL
52		PIN, ROLL	126	08562C-3	GRIP PISTOL
53		RECEIVER, UPPER-MIL-STD-1913	127	08562C-2	BUFFER ASSY (DOUBLE HEAVY)
54	CF61518	SPRING, COVER	128	08562C-2	BUFFER ASSY (HEAVY) (SA C8A2 ONLY)
55	CF61658	PIN, COVER HINGE	129		WEIGHT, BUFFER
56	CF64532	EJECTION PORT COVER ASSY	130	MS51958-83	DISC, BUFFER
57		LATCH, COVER	131		BODY, BUFFER
58		PIN, SPRING	132		BUMPER, BUFFER
59		EJECTION COVER LATCH HOUSING ASSY	133		WEIGHT, BUFFER, HEAVY
60	CF90402	SNAP RING, COVER HINGE PIN	134		SCREW, MACHINE, PAN HEAD
61		CAP, HANDGUARD	135		SIGHT ASSY, DETACHABLE (DIS)
62		BARREL ASSY, HEAVY, CARBINE	136		SCREW, REAR SIGHT, WINDAGE
63		BARREL ASSY, HEAVY, 10 INCH	137		DRUM, WINDAGE
64		BARREL, HEAVY, CARBINE	138		SPRING, REAR SIGHT
65		BARREL, HEAVY, 10 INCH	139		SPRING, REAR SIGHT DETENT
66	09126C-1	EXTENSION, BARREL	140		DETENT, REAR SIGHT
67	CF61705	PIN, BARREL INDEXING	141		SIGHT, REAR
68	CF61709	WASHER, COMPENSATOR, CONSTANT TORQUE	142		SHAFT, SIGHT CLAMP, HEADED
69	8890107-1	PIN, TAPER, FRONT SIGHT	143		WING NUT ASSY
70	CF62381	DETENT, FRONT SIGHT	144		BODY, SIGHT RAIL
71	CF62374	SPRING, FRONT SIGHT DETENT	145		CLAMP, SIGHT
72	CF62380	POST, FRONT SIGHT	146		WASHER, WAVE
73	08012C-2	HANDGUARD ASSY	147		PIN, ROLL
74	11493C-1	HANDGUARD	148		MAGAZINE ASSY (DRILLED BODY)
		LINER, HANDGUARD	149		FOLLOWER, MAGAZINE
		SPARE BARREL ASSY, C8A2	150		SPRING
		SPARE BARREL ASSY, CQB	151		BODY, MAGAZINE
			152		BASEPLATE, MAGAZINE
					MAGAZINE ASSY, 30 ROUND
					FOLLOWER, MAGAZINE, PLASTIC
					SPRING, MAGAZINE, 30 ROUND
					BOX, MAGAZINE, 30 ROUND
					PLATE, BOTTOM, MAGAZINE